

Part #: 9256
Description: STT Bumper Installation
Date: 3/11/03

Instructions for Installing the 9256 STT Bumper

1. Prepare the machine so there is easy and safe access to the work area. Maintain all safety related work procedures. Stop the engine, remove the ignition key and wait for all moving parts to come to a complete stop. Always wear eye and hand protection.
2. Install the bumper mounting brackets to the rear of the machine using the hardware provided with this kit. See Figure 1. Tighten the hardware.
3. Install the STT Bumper to the mounting brackets and secure with the ring pins and cotter hair pins supplied with this kit. See Figure 1.

-NOTE-

The STT Bumper will need to be removed to access the rear pump plate when servicing. Remove the two (2) ring pins and hair pin cotters. Slide the bumper upward out of the mounting brackets to remove.

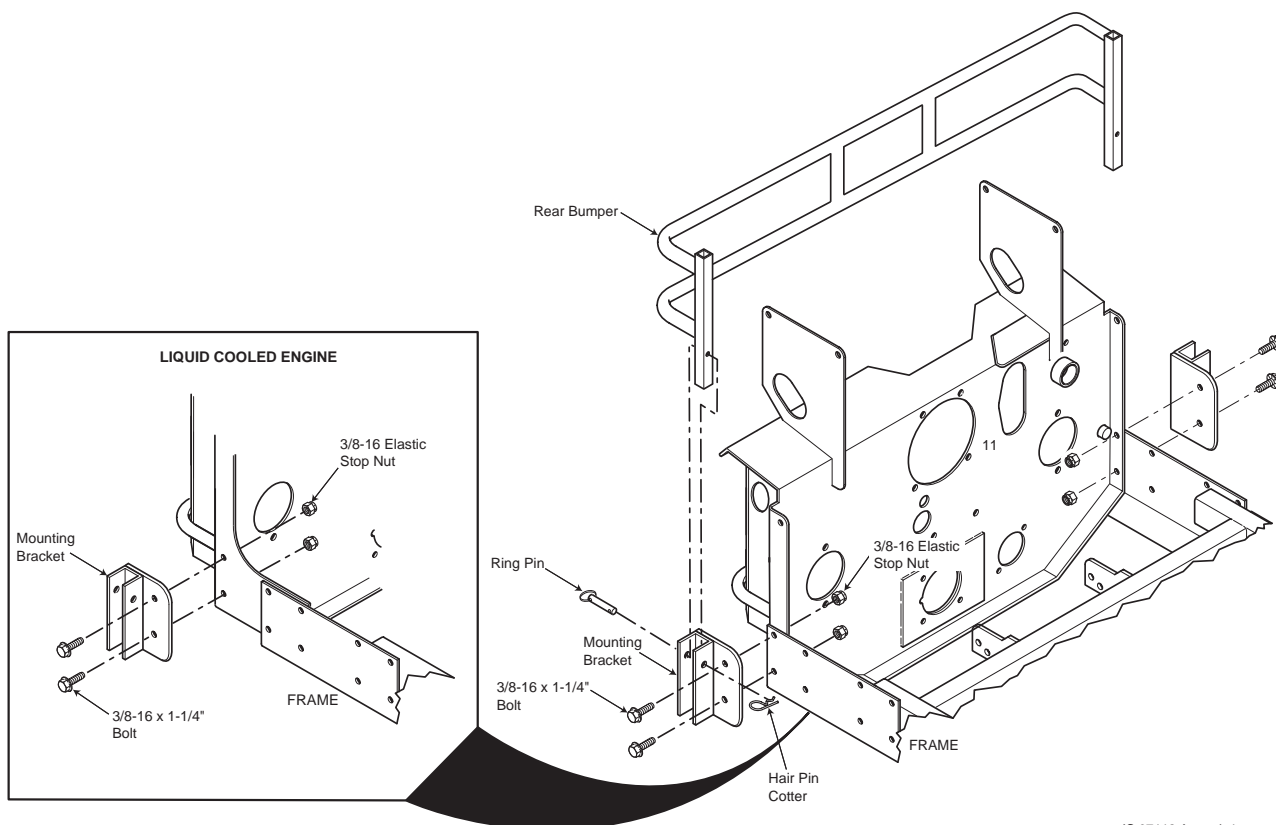

IS 07112 Artwork 1

Figure 1. STT Bumper Installation

-NOTE-

Illustration is for reference only.