

Part #: 921A
Description: SCZ - Light Kit Installation
Date: 8/20/2010

Instructions for Installing the 921A SCZ Light Kit

-WARNING-

Only mow in daylight. This light kit is not intended for mowing, or for operation on public roads. This is intended for transport to and from trailers and movement in storage facilities

-NOTE-

Please read through and become familiar with these instructions before beginning to install this kit. For pictorial clarity, illustrations used in this instruction may show some parts removed from the mower.

The following tools are required for installation of this light kit.

- 1 - 3/8" wrench or socket*
- 1 - 7/16" wrench*
- 1 - 7/16" socket*
- 1 - 1/2" wrench or socket*
- 1 - sidecutter*

1. Prepare the machine so there is easy and safe access to the work area. Maintain all safety related work procedures. Stop the engine, remove the ignition key and wait for all moving parts to come to a complete stop. Disconnect the positive cable from the battery. Always wear eye and hand protection.
2. Using the hardware provided, assemble the lights to the mounting brackets as shown in Figure 1. Do not tighten the hardware at this time.

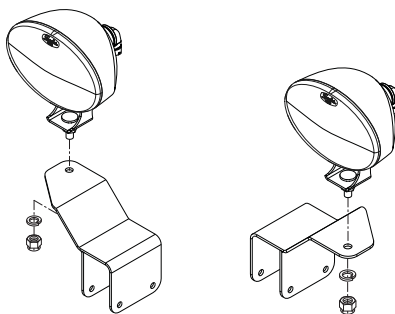

Figure 1. Assemble Lights to Mounting Brackets

3. Install the (2) two light and bracket assemblies onto the frame of the machine and secure using (4) four 1/4-20 x 2" hex head bolts and (4) 1/4-20 center locknuts provided with this kit. See Figure 2. Page 2. Do not tighten hardware at this time.

Part #:	921A
Description:	SCZ - Light Kit Installation
Date:	8/20/2010

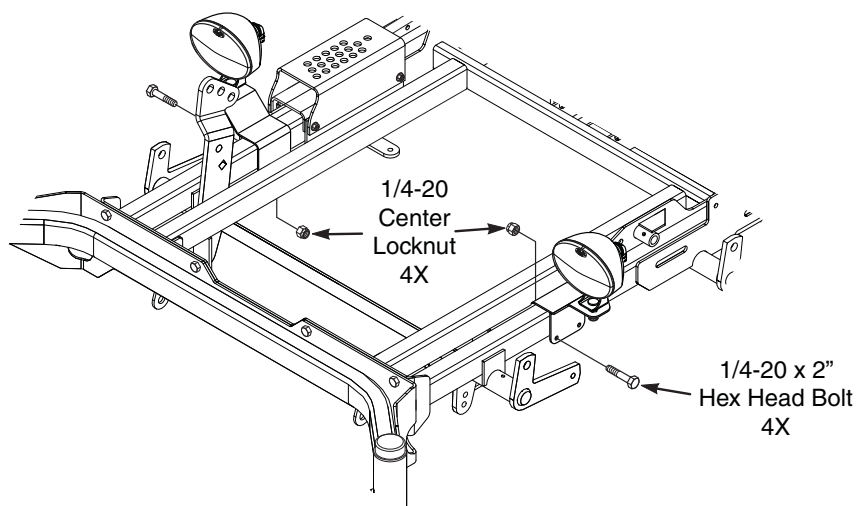

Figure 2. Install Light & Bracket Assemblies

4. Remove the dash panel from the right hand fuel tank. Identify the location of the hole provided in the panel. Carefully cut the dash panel decal to reveal the mounting hole for the light switch. See Figure 3.

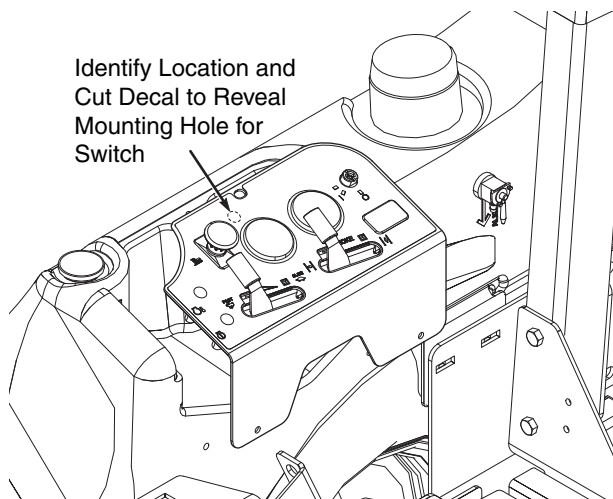

Figure 3. Reveal Mounting Hole for Switch

5. Install the light switch and rubber switch boot to the dash panel.
6. Connect the wire harness provided with this kit to the light switch that was installed in the previous step. Do not connect the light kit wire harness to the machine wire harness at this time.

Part #: 921A
Description: SCZ - Light Kit Installation
Date: 8/20/2010

7. Route the light kit wire harness as shown and connect to the LH and RH light assemblies. See Figure 4.

- Note -

Lowering the cutter deck to the lowest position will provide additional clearance to ease installation of the wire harness to the frame cross tube.

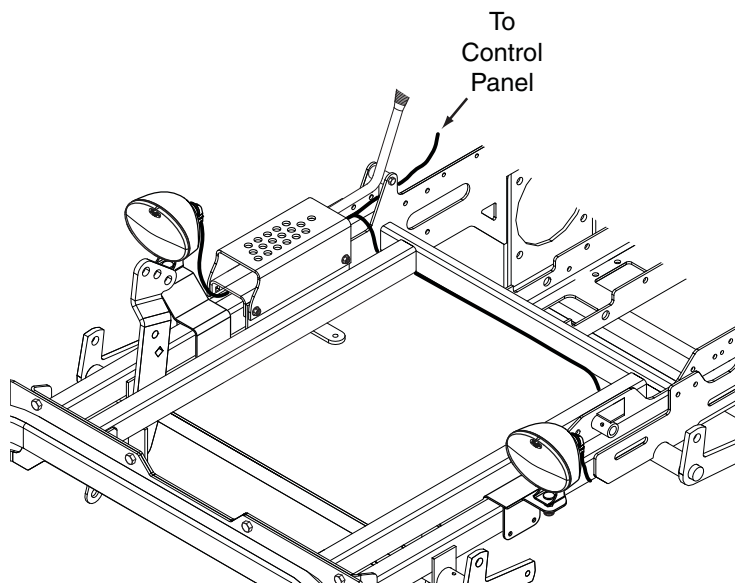

Figure 4. Route Wire Harness and Connect to Lights

8. Secure the wire harness to the frame of the machine using the cable ties provided with this kit.
9. Identify the open connector in the machine wire harness located under the dash panel. This connector can be identified by having (2) two RED and (2) two BLACK wires.
10. Connect the light kit wire harness to the connector identified in the previous step.
11. Reinstall the dash panel to the fuel tank.
12. Reconnect the positive battery cable to the battery.
13. Operate and test.

- NOTE -

The ignition key switch must be in the ON position for the light kit to operate

14. Aim the lights forward and slightly downward.
15. Tighten the mounting hardware.