

Part #: 923E
Description: STTII Light Kit Install
Date: 2/16/16

Instructions for Installing the 923E STTII Light Kit

-WARNING-

Only mow in daylight. This light kit is not intended for use while mowing, or for operation on public roads. This is intended for transport to and from trailers and movement in storage facilities.

1. Prepare the machine so there is easy and safe access to the work area. Maintain all safety related work procedures. Stop the engine, remove the ignition key and wait for all moving parts to come to a complete stop. Always wear eye and hand protection.
2. Remove the two rear mounting bolts from the cutter deck height adjustment bracket. Install the right hand light bracket to the rear holes on the cutter deck height adjustment bracket. See Figure 1. Secure using (1) one 5/16-18 x 1" bolt, (1) one 5/16-18 serrated flange nut and the self tapping bolt removed from the center hole. See Figure 1.
3. Install the light switch and switch cover to the right hand mounting bracket and secure. See Figure 1.
4. Remove the front mounting bolt from the left hand control bracket. Install the left hand light bracket to the left hand control bracket. See Figure 1. Secure using (1) one 5/16-18 x 1" bolt and (1) one 5/16-18 serrated flange nut. See Figure 1.
5. Tighten the mounting bracket hardware.

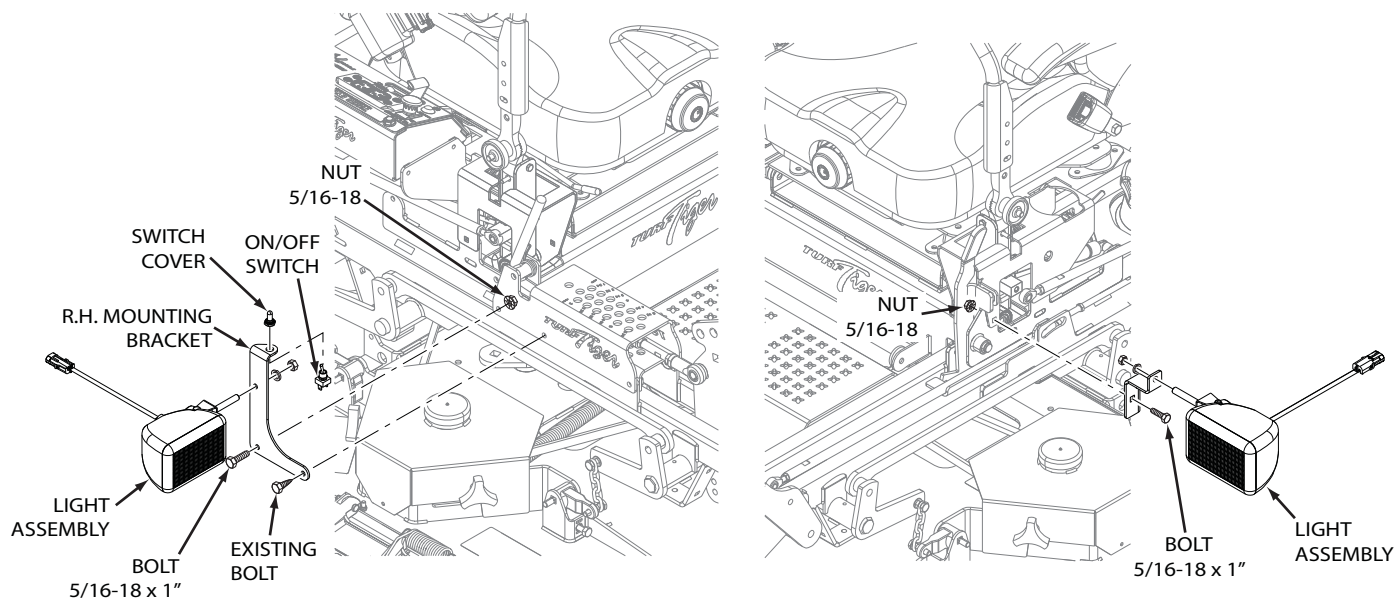

Figure 1. Light Kit Installation

6. Install the (2) two lights to the mounting brackets on the left and right sides of the machine. Aim the lights forward and tilt slightly downward. Tighten the light mounting nuts. Adjustment may be needed after installation has been completed for proper light position.
7. Install the wire harness and route as shown in Figure 2.

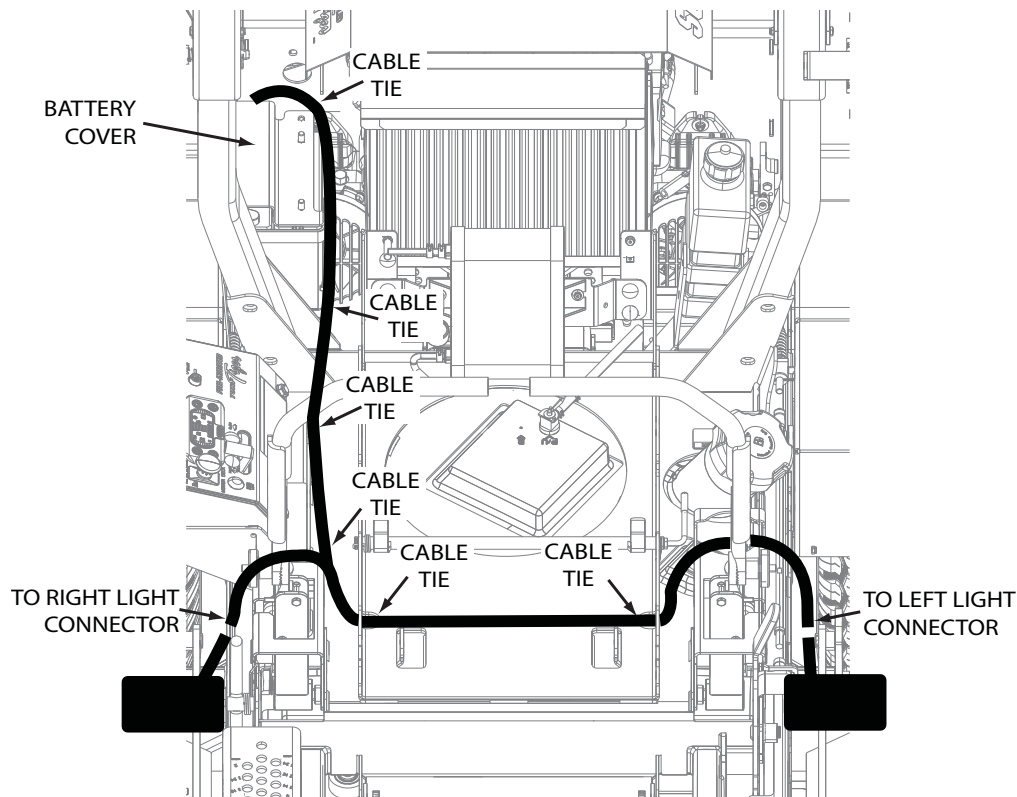

Figure 2. STT Wire Harness Routing

8. Connect the light wire harness to the light on/off switch and the right hand light assembly.
9. Route the light wire harness on the right side of the machine to the battery. See Figure 2.
10. Route the light wire harness under the seat plate following the existing wire harness over to the left side of the machine. See Figure 2.
11. Connect the light wire harness to the left hand light assembly.
12. Using the cable ties supplied with this light kit, secure the light wire harness as shown in Figure 2.
13. Lift the battery cover and connect the light wire harness to the battery.
14. Operate and test.

-NOTE-

If the lights remain on after the engine has been shut off, battery voltage will be drained and battery damage could result.