



INSTRUCTION SHEET 07256

Part #:	923J
Description:	SZL36 Armrest Installation
Date:	1/16/2017

Instructions for Installation of the #923J Armrest Accessory Kit for SZL36 Mowers

- Note -

The following tools are required for installation of this kit.

- 1 - 9/16" Socket & Ratchet
- 1 - 9/16" Wrench
- 1 - 3/8" Socket & Ratchet or Wrench
- 1 - 16mm Socket with Extension & Driver

1. Prepare the machine so there is easy and safe access to the work area. Remove the ignition key and disconnect the spark plug wires. Maintain all safety related work procedures. Always wear eye and hand protection.
2. Remove and discard the original hardware used to secure the LH & RH steering control levers to the control lever bars. Place one spacer block (provided) between each steering control lever and control lever bar. Secure using the 3/8"-16 x 1-3/4" hex head bolts, 3/8" lock washers and 3/8" flat washers supplied with this kit. See Figure 1.

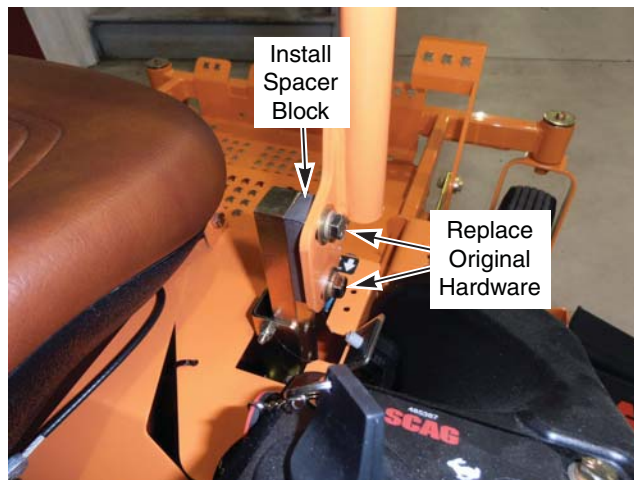

Figure 1. Install Spacer Blocks

3. In order to install the armrest assemblies onto the seat, six speed nuts (supplied with kit) will need to be installed. Indents are provided on the seat shell to indicate the proper locations. See Figure 2, Page 2.

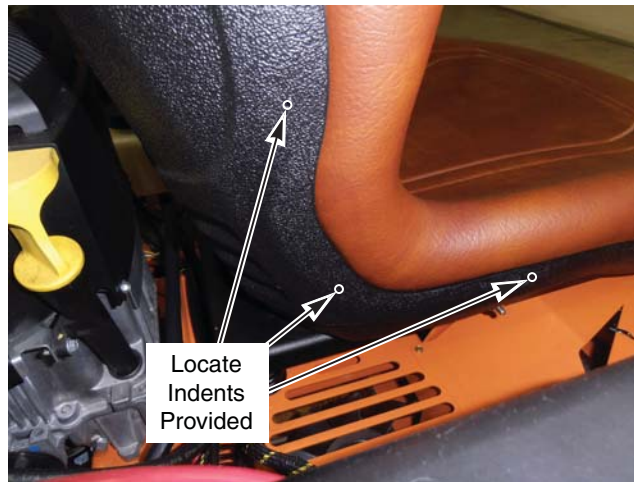

Figure 2. Locate Indents

4. Install three speed-nuts onto the RH side of the seat shell. The flat surface of the speed-nuts are to be on the outside of the seat shell with the threaded portion placed between the seat cushion and the seat shell. A recessed pocket is molded into the inside of the seat shell to locate each speed-nut. When installed properly the indents located in the previous step will line-up with the hole center of the speed-nut(s). See Figure 3.



Figure 3. Install Speed-Nuts

- Note -

If glue is present in the recessed pocket provided in the seat shell for the speed-nut(s), it will need to be carefully removed using a flat bladed screw driver or sharp chisel in order to allow the speed-nut(s) to seat fully into the pocket. Use extreme care not to damage the seat cushion.

5. Assemble one (1) armrest onto the LH armrest bracket as shown in figure 4 and secure using one (1) 3/8-16 x 1-3/4" hex head bolt, one (1) 3/8-16 hex nut with thread locking patch and two (2) spacers provided. Repeat this assembly procedure for the RH armrest and armrest bracket. See Figure 4.

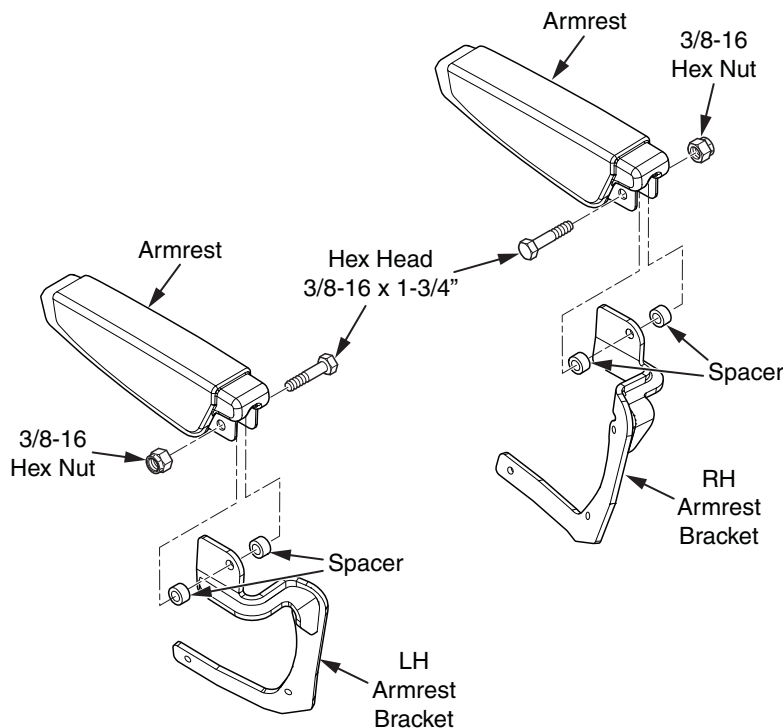

Figure 4. Assemble Armrest to Bracket

6. Install the RH armrest assembly onto the seat by aligning the holes provided in the armrest mounting bracket with the speed-nuts installed in step 4 and secure using three (3) 1/4" x 1" self-tapping screws provided. Torque the self-tapping screws to approximately 50 - 70 in.lbs. DO NOT over tighten. See Figure 5.



Figure 5. RH Armrest Assembly

7. Repeat the procedure outlined in step 6 for installation of the LH armrest.
8. The amount of pressure required to raise and lower the armrests can be adjusted to your personal preference. This adjustment is made by increasing or decreasing the tension on the armrest pivot bolt(s) installed in step 5.
9. The operators position/elevation of each armrest is adjusted using a 16mm socket with an extension and driver. The adjustment screw is located in the bottom of the armrest and is accessible when in the raised position.
10. Reconnect the spark plug wires.
11. Operate and test.