

Part #: 9610P
Description: Swivel Caster Kit Installation
Date: 11/20/2018

Instructions for Installing the 9610P Swivel Caster Kit

-NOTE-

Please read through and become familiar with these instructions before beginning to install this kit. For pictorial clarity, illustrations used in this instruction may show some parts removed from the blower.

*The following tools are required for installation of this swivel caster kit.
1 - 3/8" wrench or socket*

1. Prepare the machine so there is easy and safe access to the work area. Maintain all safety related work procedures. Stop the engine, make sure the ignition switch is in the OFF position, and wait for all moving parts to come to a complete stop. Always wear eye and hand protection.
2. Begin by removing the 3/8 elastic stop nuts w/ flange(3) that hold the original front wheel on. Save these, you will use them to install the new caster assembly.
3. While using something to support the blower or an assistant, remove the original front wheel.

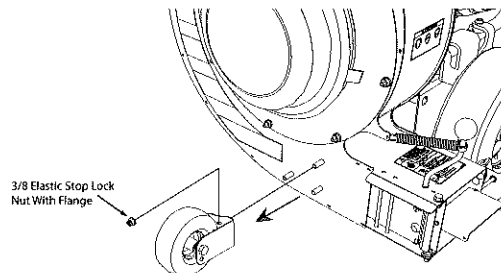

Figure 1. Removing Original Wheel

4. Once the original wheel is removed, install the swivel caster assembly onto the pins on the blower housing. Secure using 3/8 elastic stop nuts w/ flange(3).

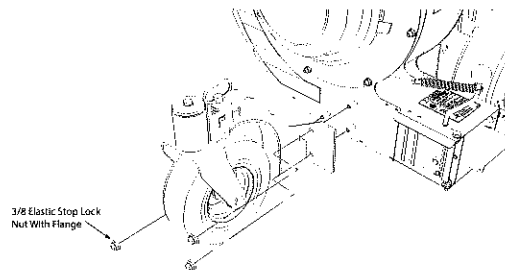

Figure 2. Installing Swivel Caster Assembly

5. Operate and test.
6. Make sure all hardware remains tight.